

Installation Guide (MV06 + MV04) : Tool Body Swivel Fitting

Step 1: Determine the model of the valve core removal tool by locating the **stamped lettering** on the main tool body swivel fitting.

If the tool body swivel fitting has stamped lettering proceed to **Step 2a** below.

If the tool body swivel fitting does **NOT** have stamped lettering proceed to **Step 2b** below.

Step 2a:

Use an O-Ring from the bag labeled **MV06**.

Use a bent pick to remove and replace the o-ring as illustrated.

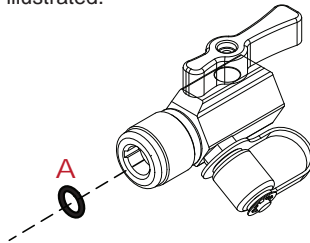

Note: Apply Clean Vacuum Pump Oil or Vacuum Grease to all of the o-rings **prior** to installation.

O-Ring Sizing Guide



Step 2b:

Select the appropriate o-rings from the bag labeled **MV04** & check it against the below **O-Ring Sizing Guide**.

Use a bent pick to remove and replace the 2 o-rings as illustrated.

Use **C** for 1/4" tool
or
Use **D** for 5/16" tool

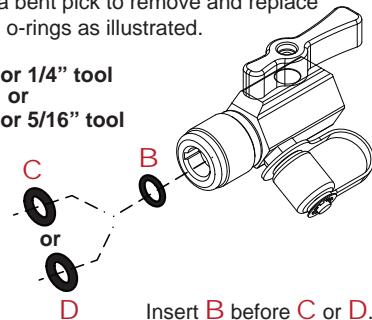

Note: Apply Clean Vacuum Pump Oil or Vacuum Grease to all of the o-rings **prior** to installation.

O-Ring Sizing Guide

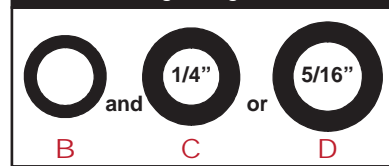

Installation Guide (MV07): Tool Body

Step 1:

Disassemble tool body as illustrated.

Step 2:

Replace seals and o-rings with the new ones as illustrated.

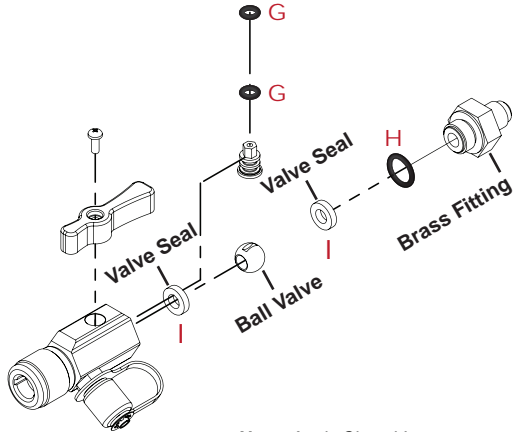

Step 3:

Turn **ball valve** to the Closed position before re-attaching the **brass fitting**.

Note: Apply Clean Vacuum Pump Oil or Vacuum Grease to all of the o-rings **prior** to installation.

O-Ring & Seal Sizing Guide

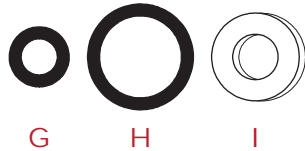

Installation Guide (MV08) : Stem Assembly

Step 1:

Use a **2mm Allen Key** to loosen magnet and handle from the stem.

Step 2:

Take the **stem** out of the **handle**, and slide the **stem fitting** off.

Step 3:

Use a bent pick to remove the **o-rings** and **stem support**.

Step 4:

Install the new **o-rings** and replace the **stem support** into the **stem fitting** as illustrated.

Step 5:

Slide the **stem** through the **stem fitting**.

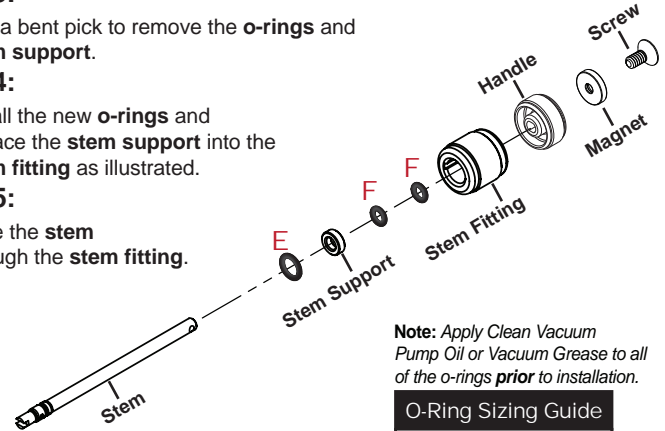

Note: Apply Clean Vacuum Pump Oil or Vacuum Grease to all of the o-rings **prior** to installation.

O-Ring Sizing Guide



Step 6:

Line up the holes on the **handle**, **magnet** and **stem**.

Replace screw with 2mm Allen key

For a video tutorial and more helpful videos visit:
www.YouTube.com/AppionTools